



DOUBLETREE
BY HILTON™

ROCKY MOUNT HOTEL

651 N. Winstead Ave.
Rocky Mount, NC 27804

Conveniently located one mile from I-95 off Highway 64, the award-winning DoubleTree by Hilton Hotel Rocky Mount offers an ideal location with excellent amenities. A warm DoubleTree Chocolate Chip Cookie on arrival is simply the start of the welcoming hospitality you'll receive at our Rocky Mount hotel in North Carolina.

Each spacious guest room and suite is designed for absolute comfort and a great night's sleep. Enjoy one king-sized bed or two queen-sized beds, a 43-inch flat-screen LCD HDTV, work desk with an ergonomic chair, a refrigerator and microwave. Appreciate little extras that mean a lot, such as complimentary WiFi throughout this Rocky Mount hotel in NC, and complimentary parking.

Relax in your guest room or suite, or in our spacious welcoming lobby with comfy seating for guests to talk and unwind. Swim in our heated outdoor pool and enjoy the whirlpool. Enjoy our Manager's Reception on Tuesdays for free hors d'oeuvres.



POINTS OF INTEREST

- Nash UNC Health Care .9 MI
- Rocky Mount City Lake 3 MI
- Sunset Park 3 MI
- Rocky Mount Mills 3 MI
- Rocky Mount Event Center 4 MI
- Battle Park 4 MI
- Stonewall Mansion 4 MI
- Rocky Mount Train Station 5 MI
- City Center 5 MI
- Golf Courses 5 MI
- Pfizer 6.5 MI
- N.C. Wesleyan College 6.8 MI
- Honeywell 9 MI
- Cummins 12 MI

FEATURES:

- Business Center
- Chocolate Chip Cookie at Check In
- Complimentary Printing Service
- Express Mail
- Secretarial Service
- 24 Hour Pavilion Pantry Market
- Baggage Storage
- Coin Laundry
- Electric Car Charging Station
- Room Service
- Fitness Room
- Outdoor Heated Pool & Hot Tub
- Photo Copying Service

GUEST ROOM INFORMATION:

- 43-inch Flat Screen TV
- Work Desk
- Refrigerator
- Microwave
- In-Room Coffee

MEETING ROOMS:

- 2,484 Total Sq. Ft. Event Space
- 6 Meetings Rooms
- On-site Catering
- A/V Equipment Services

DINING:

- Texas Steakhouse & Saloon

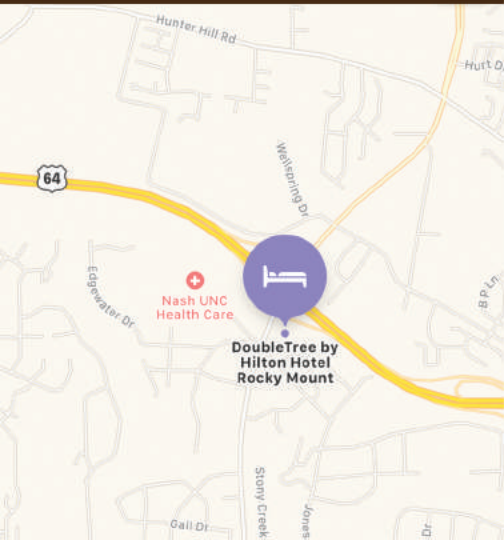



DOUBLETREE BY HILTON ROCKY MOUNT HOTEL

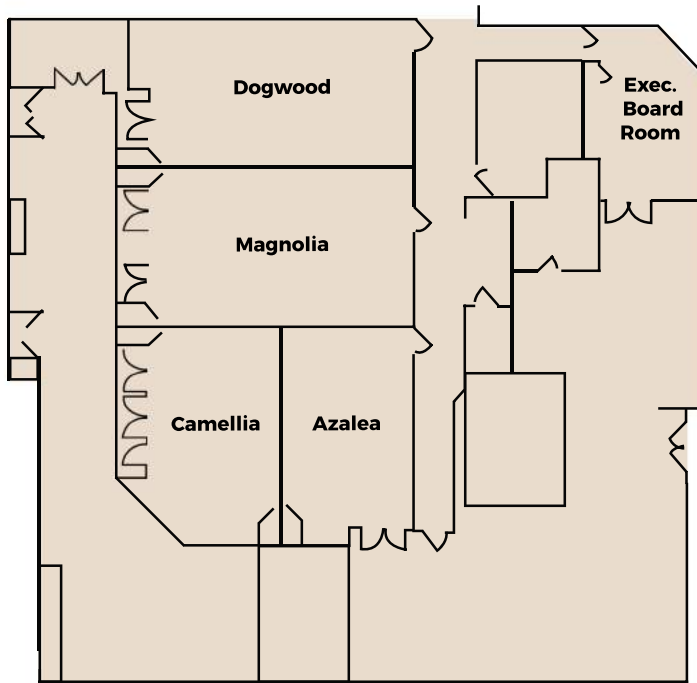

PLAN AN EVENT:

DoubleTree by Hilton Hotel Rocky Mount makes planning and hosting your meeting easy. Whether you are organizing a conference, sales presentation, corporate retreat, theme party or formal affair, we will accommodate them all. Rely on our expertise to provide the perfect setting for any occasion. Our meeting services include in-house A/V services, first-class catering facilities and experienced personnel to ensure your event is a success.

MEETING & EVENT HIGHLIGHTS:

- 2,484 total square feet of event space
- 6 meeting rooms seat up to 200 people
- On-site catering
- A/V equipment services

Room Name	Room Size	Banquet Round Tables	Capacity					
			Classroom	Theatre	Conference	Reception	Exhibits	U-Shape
Ceiling Height up to 12'								
Camellia (486 sq. ft.)	18'X27'	30	30	50	20	50	12	20
Azalea (486 sq. ft.)	18'X27'	30	30	50	20	50	12	20
Magnolia (756 sq. ft.)	36'X21'	50	50	75	30	75	15	30
Dogwood (756 sq. ft.)	36'X21'	50	50	75	30	75	15	30
Grand Ballroom (2,484 sq. ft.)	69'X36'	175	160	200	100	300	54	100
Boardroom					12			

